

Cedervall forward split water lubricated stern-tube seal type CREW

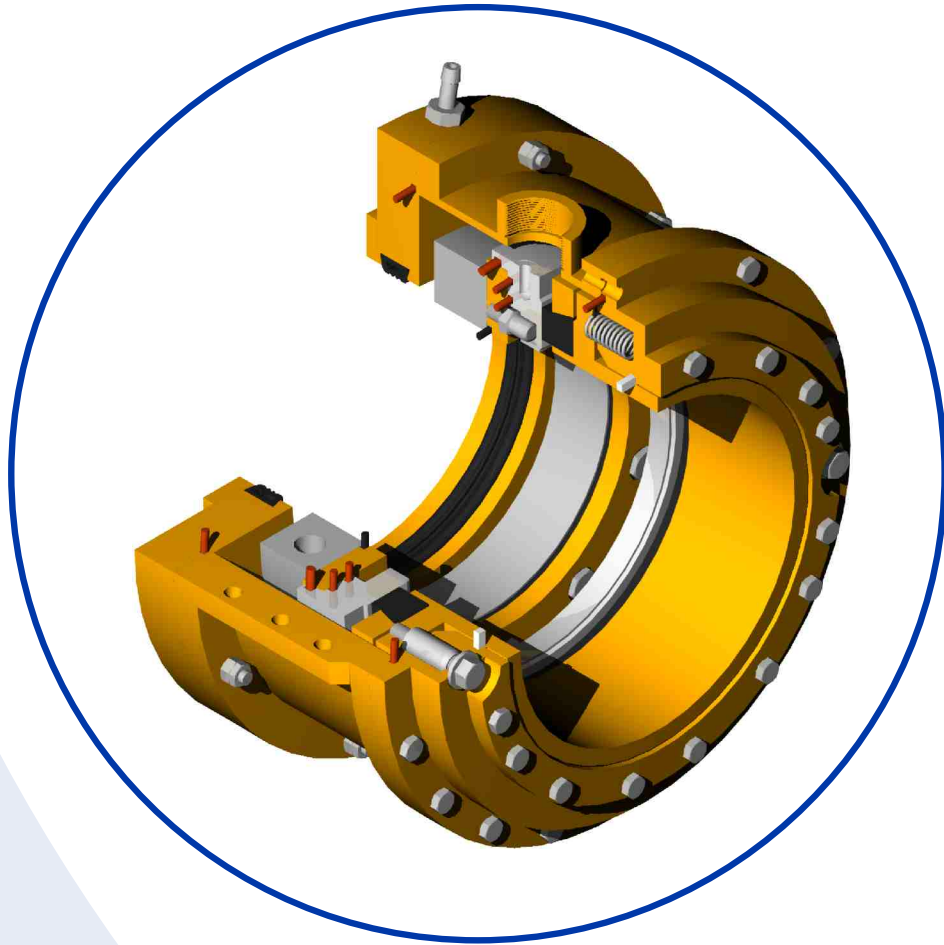

Cedervall inboard seal type CREW has been designed to provide sealing of propeller shafts with water lubricated bearings. It could be used for all purpose sea- and river going vessels for either closed or open lubrication system.

Seal has fully split housing, what makes possible replacement of wearing face without shaft's uncoupling. Design allows significant radial shaft's displacement due to wear in bearing. Static inflatable secondary seal - "pneumostop" provides inspection and rebuilding of the seal with water in the stern tube.

Choice of materials and cathode protection makes the seal fully corrosion resistant and safe for other surrounding pieces of equipment.

For technical specification, see back-cover of this leaflet.

www.cedervall.com



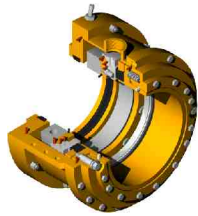

Cedervall forward split water lubricated stern-tube seal type CREW

All dimensions in mm.

Size	D	-	D ₁	A	B	C	N x E
6	186	-	204	362	341	255	8 x M10
7	205	-	228	442	414	285	8 x M12
8	229	-	246	460	432	285	8 x M12
9	247	-	264	478	450	285	8 x M12
10	265	-	283	510	475	285	8 x M16
11	284	-	302	530	495	285	8 x M16
12	303	-	321	565	525	285	8 x M20
13	322	-	339	580	540	285	8 x M20
14	340	-	358	600	560	285	10 x M20
15	359	-	377	620	580	285	10 x M20
16	378	-	396	640	600	285	10 x M20

Size	D	-	D ₁	A	B	C	N x E
17	397	-	415	655	615	298	10 x M20
18	416	-	432	675	635	298	10 x M20
19	433	-	451	695	655	298	10 x M20
20	452	-	470	715	675	298	12 x M20
21	471	-	491	735	695	298	12 x M20
22	492	-	510	755	715	298	12 x M20
23	511	-	535	780	740	298	12 x M20
24	536	-	554	800	760	298	12 x M20
25	555	-	573	820	780	298	12 x M20
26	574	-	592	840	800	298	12 x M20
27	593	-	611	860	820	298	12 x M20

Each seal suits shaft diameters between D and D₁ above!

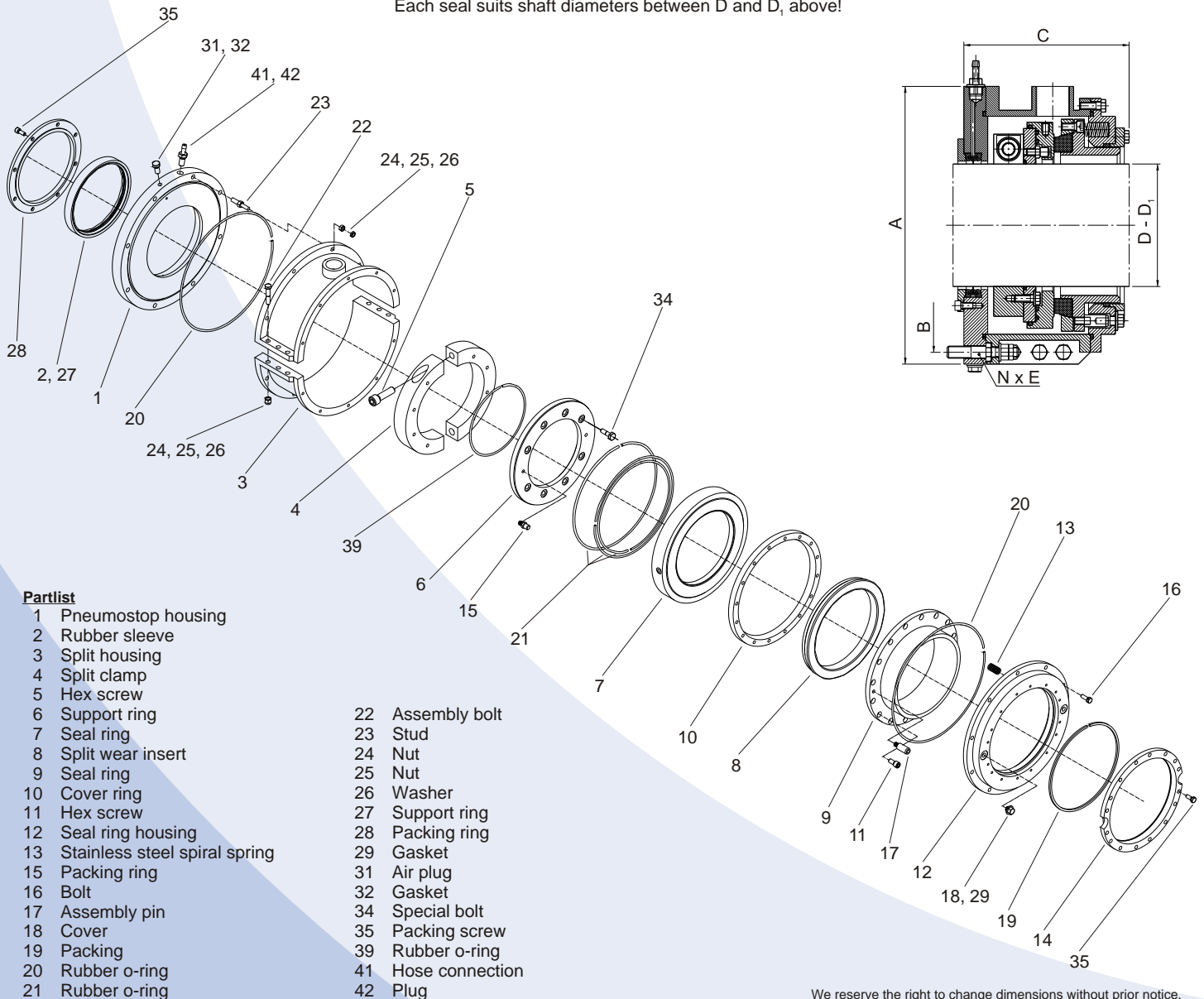

Partlist

- | | | | |
|----|-------------------------------|----|-----------------|
| 1 | Pneumostop housing | 22 | Assembly bolt |
| 2 | Rubber sleeve | 23 | Stud |
| 3 | Split housing | 24 | Nut |
| 4 | Split clamp | 25 | Nut |
| 5 | Hex screw | 26 | Washer |
| 6 | Support ring | 27 | Support ring |
| 7 | Seal ring | 28 | Packing ring |
| 8 | Split wear insert | 29 | Gasket |
| 9 | Seal ring | 31 | Air plug |
| 10 | Cover ring | 32 | Gasket |
| 11 | Hex screw | 34 | Special bolt |
| 12 | Seal ring housing | 35 | Packing screw |
| 13 | Stainless steel spiral spring | 39 | Rubber o-ring |
| 15 | Packing ring | 41 | Hose connection |
| 16 | Bolt | 42 | Plug |
| 17 | Assembly pin | | |
| 18 | Cover | | |
| 19 | Packing | | |
| 20 | Rubber o-ring | | |
| 21 | Rubber o-ring | | |

We reserve the right to change dimensions without prior notice.

www.cedervall.com

